

REV	DATE	DESCRIPTION	DESIGNED	CHECK	APPROVED

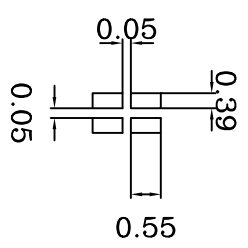
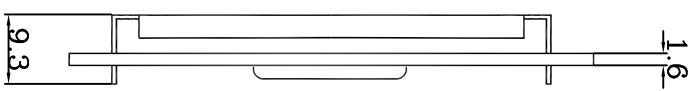
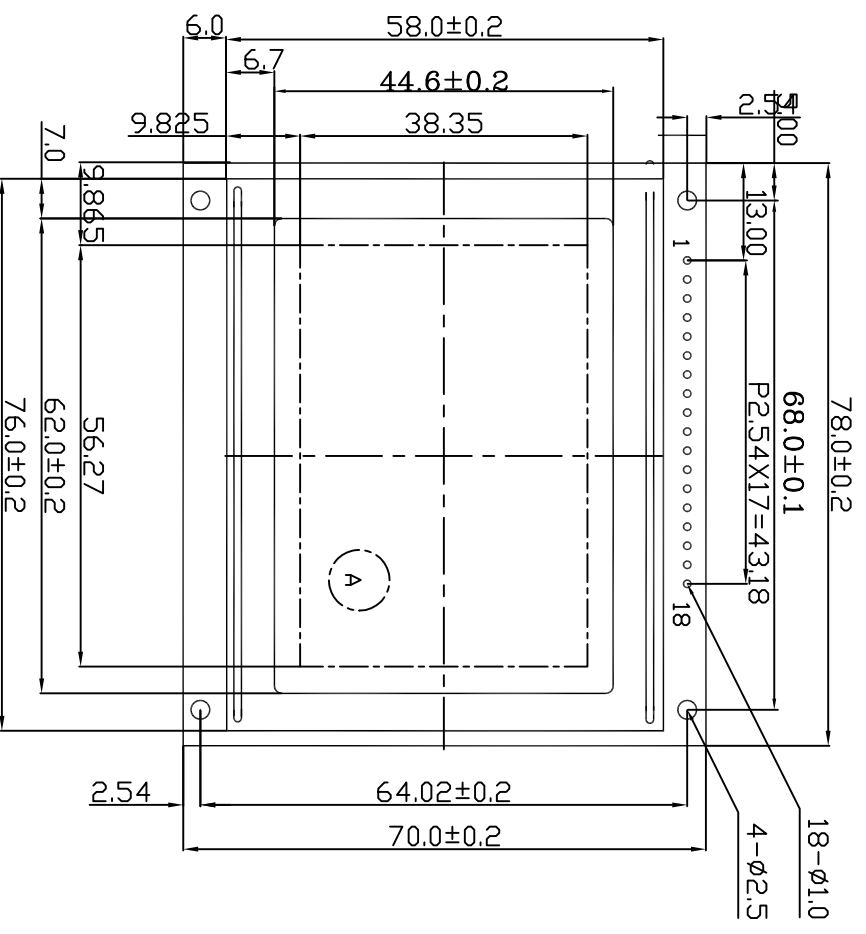

Pin No.	1	2	3	4	5	6	7	8	9~16	17	18
Symbol	CSA	CSB	VSS	VDD	VO	RS	R/W	F	DB0~DB7	A	K

NOTE:

1. DISPLAY MODE: STN-Y/G, POSITIVE/TRANSFLECTIVE
2. VIEWING DIRECTION: 6:00
3. OPERATION TEMP: -20° C - +70° C
4. STORAGE TEMP: -30° C - +80° C
5. DRIVE METHOD: 1/6DUTY, 1/9BIAS
6. CONTROLLER: NT7107
7. VDD=5.0V, ILED=45mA (@VLED=5.0V), COLOR: WHITE